

Whitechapel
Gallery

Visiting Whitechapel Gallery Visual Story Guide

Information to help you prepare for your visit



Welcome to Whitechapel Gallery

We are a big stone and brick building on Whitechapel High Street. Entrance to the building is free, offering ticketed and free exhibitions every season.



If you are walking on the high street, you will see this pillar which will guide you towards our entrances.



Entrance and Exit

The main entrance is step-free and the doors on the left hand side are assisted.



The Cafe entrance has steps and is right next to the Aldgate East station exit.



Opening times

Mondays the gallery is closed.

Tuesday to Sunday we are open
11am - 6pm.

On Thursdays we are open until 9pm
and after 6pm all exhibitions are free.

Bookshop is open during our opening
times.

Cafe is open from 10am - 4pm,
Tuesday to Sunday and on Thursdays
it's open until 9pm.



Arriving before 11am

The main gallery doors are not open
to the public until 11am. However, the
office and reception are open and
if you are arriving for an event or a
meeting you can enter through the left
hand side door of the main entrance.



Our address and location

77-82 Whitechapel High St
London
E1 7QX

If you are having trouble locating us
you can call the reception on
0207 522 7888.

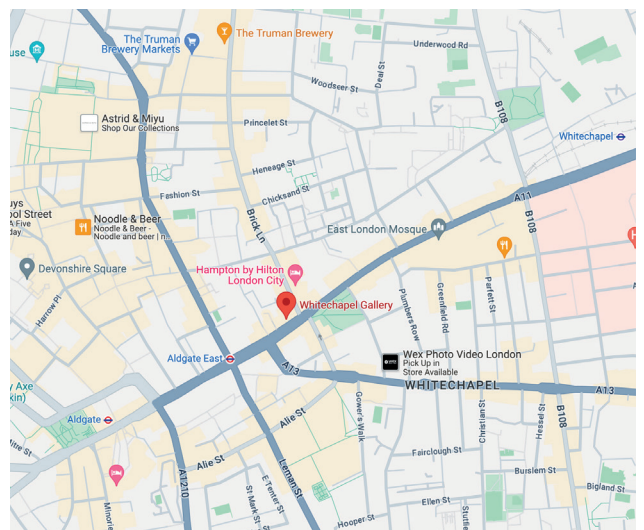

Transport Links

Tube

The nearest tube station is Aldgate East, it has 3 exits.

The gallery entrances are on either side of Exit 3.



Exits 1 and 2 are a short walk from the gallery. They are across the road from each other.



Bus

Buses 25, 205 and 254 stop outside the gallery.

The bus stop is Aldgate East (Stop E).



Car/ Taxi

There are external parking facilities nearby - please contact them directly for more information:

- NCP Whitechapel High Street
- Buckle Street Multistorey Car Park

Car and taxi drop-offs are possible on the main road opposite the entrance.

Free parking for Blue Badge holders is available at the top of Osborn Street.



Once You Get Here

Information Desk

Members of our Visitor Services team are here to welcome you and assist you with any questions you may have.

Here you can find out what exhibitions are open in which gallery spaces they are in. There are printed season guides available that you can take with you.

Access materials are also available here on request. In the last section you will find out what is available for your visit.



Ticket Desk

Here you can find out what ticket types we offer, purchase a ticket for the paid exhibition and pick up a printed season guide.

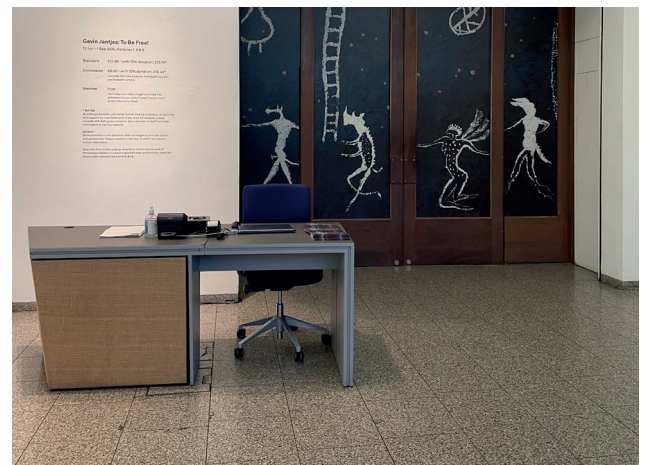

Cloakroom

Our cloakroom is free to use, but you are welcome to leave a donation.

You can leave your bags, clothes, and larger items that you do not want to take into the gallery with you. You will receive a plastic token with a number which you will need to return to collect your belongings.

At the end of your visit, we invite you to complete our feedback form and survey.



Bookshop

This is Koenig bookshop. They have books relating to our current exhibitions, magazines, postcards and some merchandise.

Bookshop is open during gallery opening hours and is free to enter.



Cafe

This summer we have a pop-up collaboration with Alba Caffè. You can buy coffee, tea, soft drinks, homemade bakes and light snacks.

Cafe is open 10am-4pm Tuesday to Sunday.

On Thursdayss they serve alcoholic beverages and are open until 9pm.



Seating area

On the ground floor, we have available seating space in the foyer next to the cloakroom.

You can have food and drinks here - whether you bought them in the cafe, or brought your own from home.

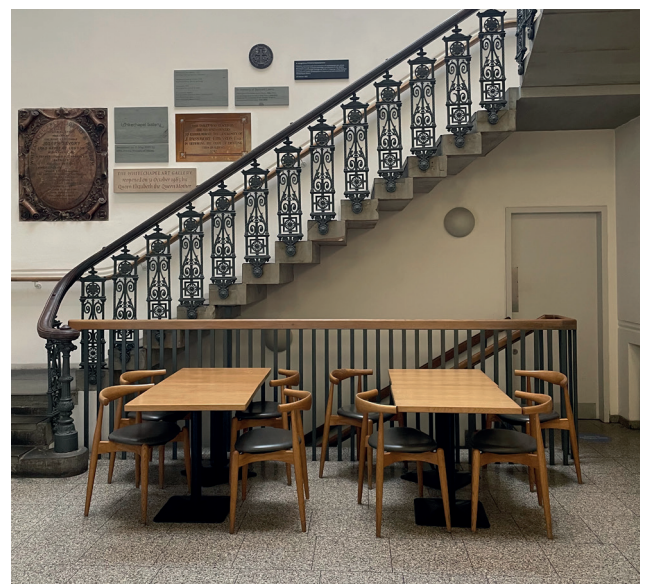

Bathrooms

There is an accessible toilet on the ground floor that has baby changing facility.



More toilets are available in the basement - you can take the stairs or the lift to go down there.

There is a private toilet with baby changing facility and an all gender cubicle, as well as women's and men's.

All toilets have complimentary sanitary products.



Whitechapel Gallery Map

Level 1

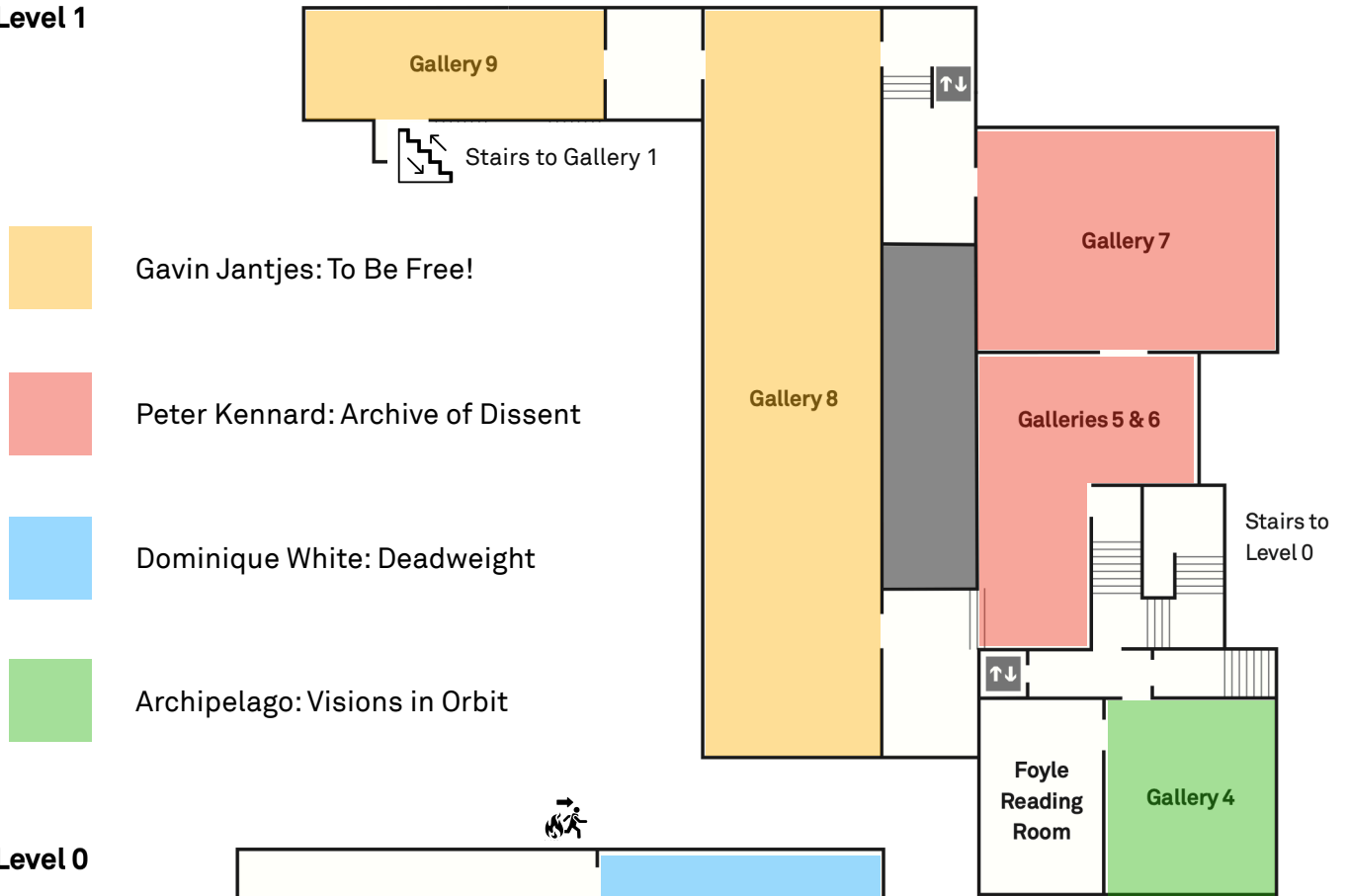





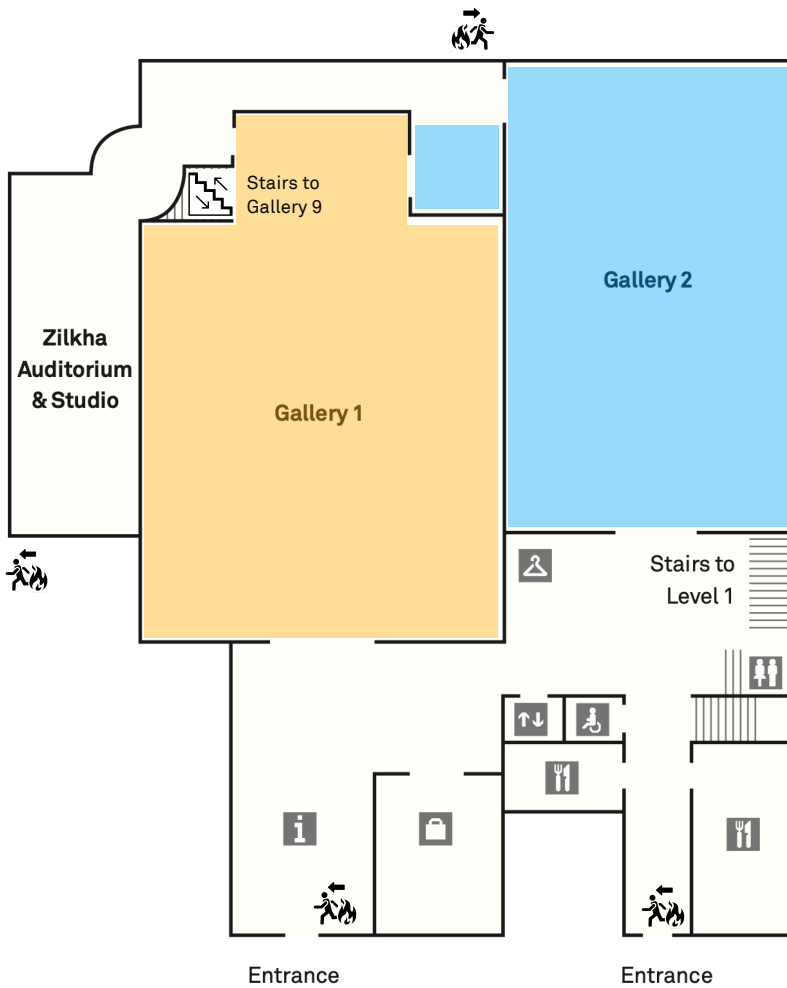



- Gavin Jantjes: To Be Free!
- Peter Kennard: Archive of Dissent
- Dominique White: Deadweight
- Archipelago: Visions in Orbit

Level 0



Key

-  Cafe
-  Cloakroom
-  Info Desk
-  Bookshop
-  Lift
-  Toilets
-  Accessible Toilet
-  Fire exit

Our Gallery Spaces

Our headline exhibitions are typically presented across Gallery 1, 9 and 8.

Gallery 1

Gallery 1 is located on the ground floor just behind the ticket desk.

There are stairs leading up to Gallery 9.

For step free access to the upper galleries, please take the foyer lift to level 1C.



Gallery 9

Accessible by stairs from Gallery 1 and connected to Gallery 8.



Gallery 8

Step free access is available via foyer lift at level 1C.

There is also a platform lift available, to take you directly into Gallery 7. Please ask a member of staff to call the Duty Manager who will assist you.



Free Displays

Galleries 2, 4, 5, 6 and 7 are always free to visit.

Gallery 7

Accessible via foyer stairs or lift level 1B. Connected to Galleries 5 & 6, as well as a platform lift to Gallery 8.



Galleries 5 & 6

These galleries are located between Gallery 8 and Gallery 7. They are accessible via foyer stairs or lift level 1B, as well as Gallery 8 and 7 exits.



Gallery 4

This Gallery is adjacent to the Foyer Reading Room. It is accessible via foyer stairs or lift level 1A.



Gallery 2

Located on the ground floor next to the cloakroom and the seating area.



Accessibility

Lift

Our passenger lift gives step-free access to all exhibitions. Capacity is 4 people max.

-1 Basement toilets

0 Information desk, Cloakroom, Gallery 1, Gallery 2, Bookshop, Cafe

1A Gallery 4

1B Galleries 5, 6 and 7

1C Gallery 8



Platform lift

Located between Gallery 8 and 7. Please ask a member of staff in either of those galleries to call the Duty Manager to assist you.

Alternatively, exit via Gallery 8 and take the passenger lift.



Wheelchair

You can borrow a wheelchair when visiting the gallery. To book it ahead of your visit email access@whitechapelgallery.org or speak to a member of staff at the Information desk upon arrival.

Portable folding chairs are available at the Cloakroom.



Assistance animals

Guide dogs, hearing and assistance dogs are welcome. If attending an event at the Zilka Auditorium, please call **0207 522 2888** in advance to book an aisle seat.

Access Materials

We provide:

- ear defenders
- ear plugs
- weighted blankets
- fidget toys
- large print season guide
- large print artwork labels
- transcripts



Induction loop

We have a portable induction loop that can be used in gallery spaces and for events. To book the induction loop or to get more information, please email access@whitechapelgallery.org or ask at the Information Desk upon arrival.



Audio description

Some of the artworks have audio descriptions available - these are available via a QR code on the artwork label or next to it.

Use your phone camera to scan and listen. If you need assistance, please ask a member of staff in the gallery space.



Large print guides

We have large print versions of the artwork labels, wall texts and the season guide. You can pick one up from a plastic holder in the exhibition space or ask a member of staff.

Copies are also available at the Information Desk.

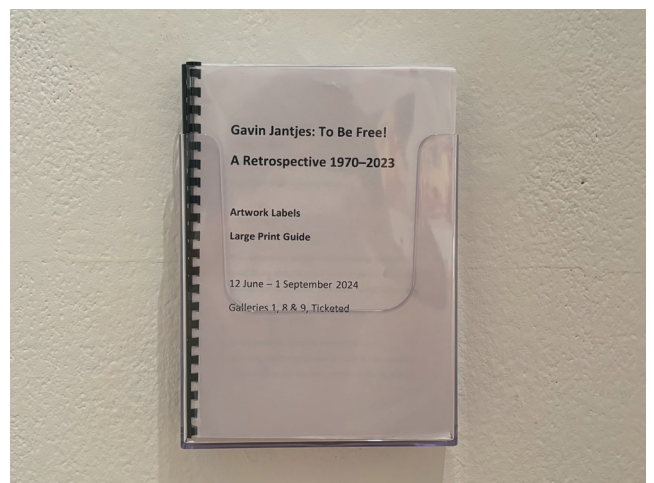

We hope that you have found this Visual Story Guide useful. It is a document that is under constant review as our building adapts and programme changes.

There will always be more information to add and we would love to hear from you about suggestions and changes that we can make, to create an accessible document that is as robust as possible.

If you have any suggestions or changes to discuss with us about the Visual Story Guide please email **access@whitechapelgallery.org**